



PRESENTED TO
Town of Middlebury Selectboard

PRESENTED BY
VTrans and VHB



Meeting with you tonight

- **Wayne Symonds, PE**, Structures Program Manager, VTrans



Current Bridge Condition

- Main Street
 - New hole in the south sidewalk early 2017
 - Continued deterioration on the south fascia
 - Currently safe for vehicles
- Merchants Row
 - New hole in the north sidewalk early 2017
 - Continued deterioration at both fascias
 - Currently safe for vehicles





Current Bridge Condition

- Freeze thaw cycle affects the deterioration of the bridges
- More holes and spalling concrete are possible
- Continued deterioration is a risk to mobility for vehicles, pedestrians, and railroad operations



Emergency Declaration

- First priority is safety of the traveling public and railroad operations
- Allows for planning, design, and construction of temporary bridges or known timeframe rather than an unplanned closure





Temporary Bridges

- VTrans inventory of Mabey bridge temporary bridges
- Lightweight steel truss modular bridges



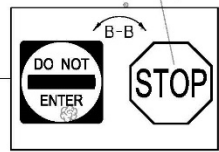
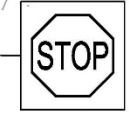
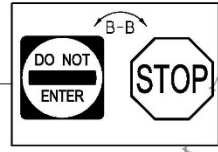
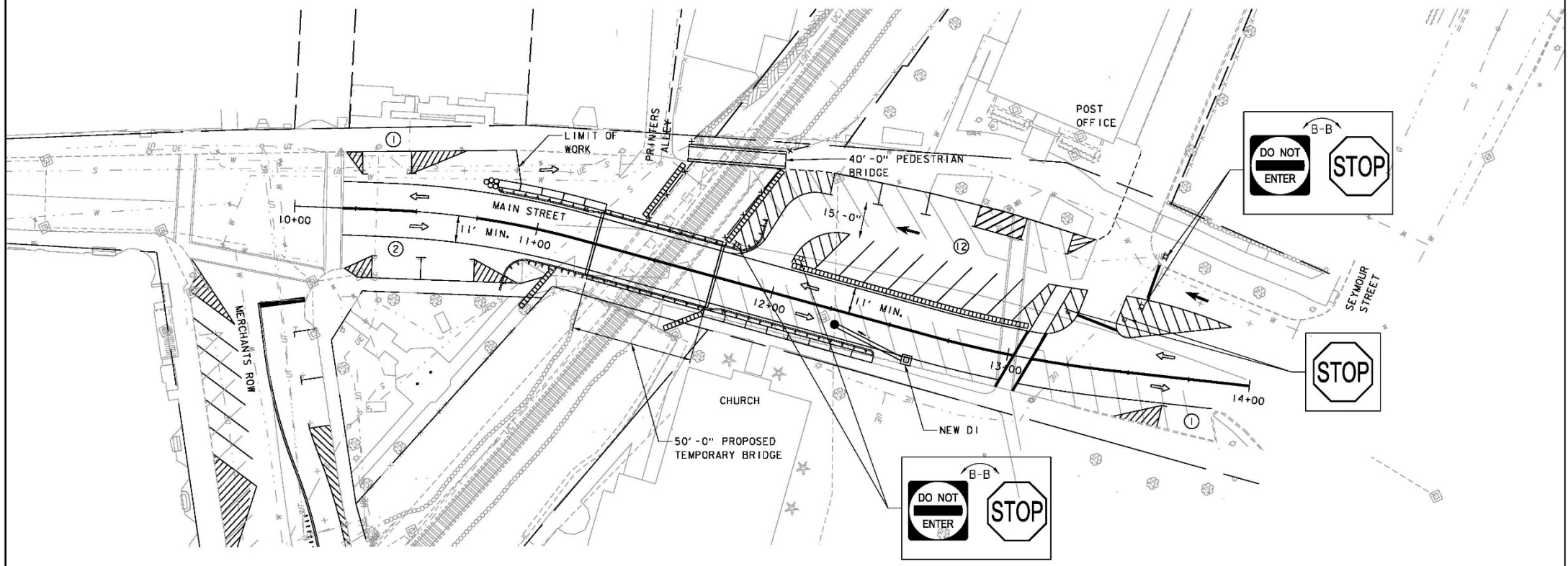
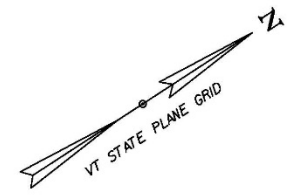

Main Street

- 2 lanes, total 24-FT wide
- Approximately 50-FT long

LEGEND

	TEMPORARY CONCRETE MEDIAN BARRIER
	RAILING
	IMPACT ATTENUATOR

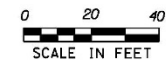

NOTES:

- MAINTAIN TWO WAY TRAFFIC ON MAIN STREET.
- RESTRICT SIDEWALK ACCESS SOUTH OF BRIDGE BETWEEN CHURCH AND TRIANGLE PARK.
- PROVIDE PEDESTRIAN BRIDGE NORTH OF TEMPORARY BRIDGE.
- MAIN STREET ON STREET PARKING:
EXISTING = 39
PROPOSED = 16

PROJECT NAME:	MIDDLEBURY
PROJECT NUMBER:	EWPS(1)
FILE NAME:	z10g044temp_bridge_main.plt
PROJECT LEADER:	A.P. GUYETTE
DESIGNED BY:	D.M. PECK
MAIN STREET TEMP. BRIDGE PLAN	
PLOT DATE:	3/27/2017
DRAWN BY:	K.C. BARRY
CHECKED BY:	S.E. BURBANK
SHEET	1 OF 4



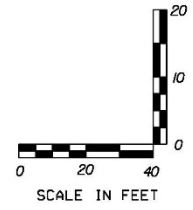
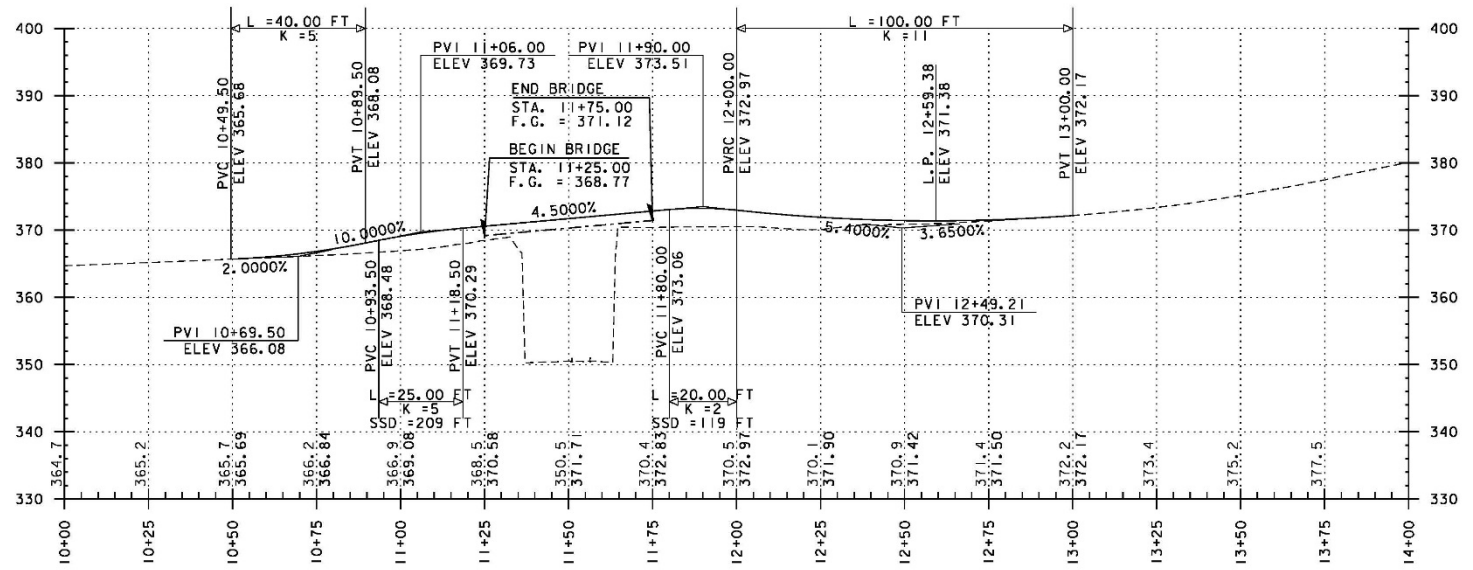

PROJECT NAME: MIDDLEBURY
 PROJECT NUMBER: EWPS(1)
 FILE NAME: z:\044temp_br\ldge.main.plt.dgn PLOT DATE: 3/27/2017
 PROJECT LEADER: A.P. GUYETTE DRAWN BY: K.C. BARRY
 DESIGNED BY: D.M. PECK CHECKED BY: S.E. BURBANK
 MAIN STREET TEMP. BRIDGE PROFILE SHEET 2 OF 4



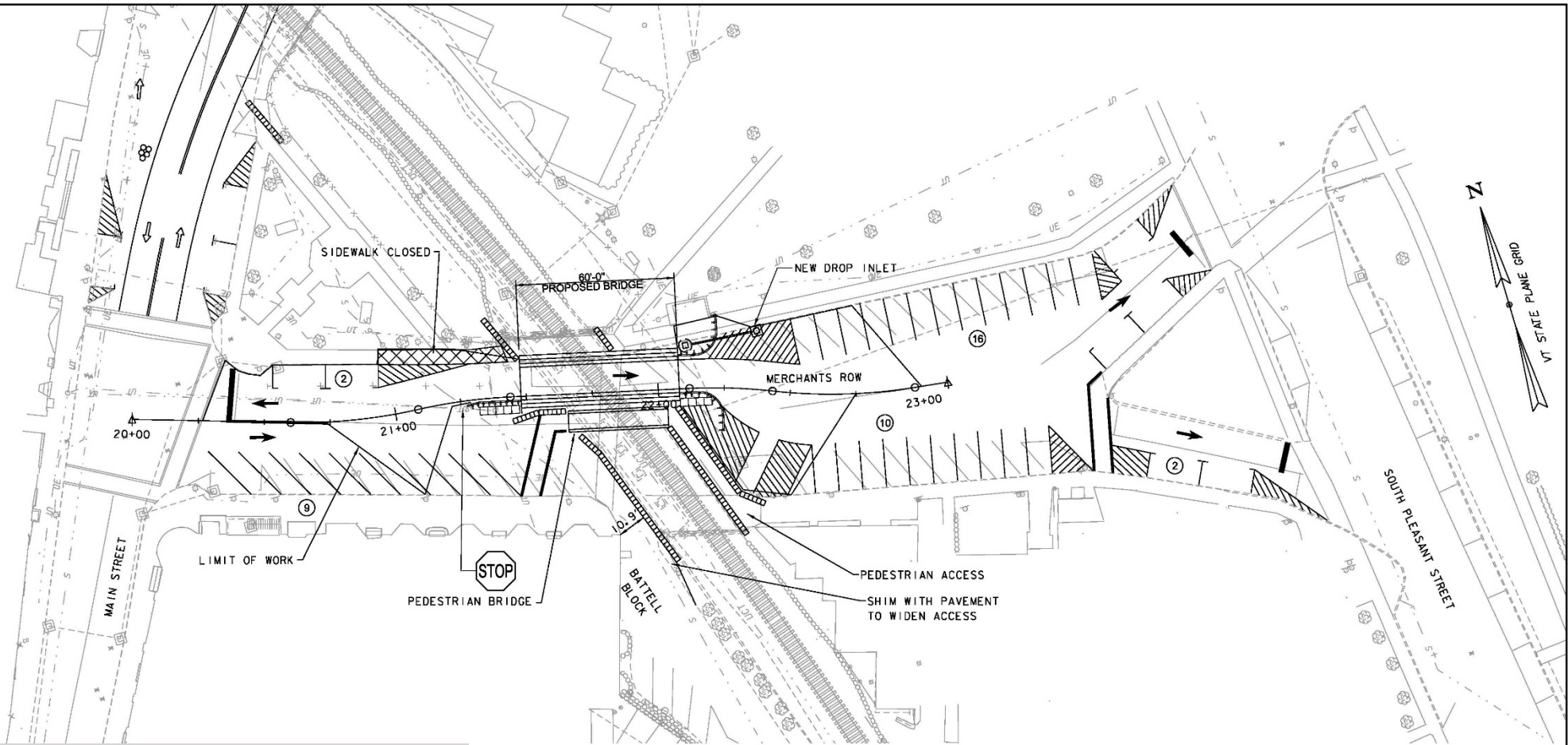

Merchants Row

- 1 lanes, total 14-FT wide
- Approximately 60-FT long
- Two-way traffic between Main Street and the bridge
- One-way traffic across the bridge and up to South Pleasant Street

LEGEND
 [Symbol] IMPACT ATTENUATOR
 [Symbol] RETAINING WALL
 [Symbol] IMPACT ATTENUATOR

NOTES:

- EAST OF BRIDGE: ONE-WAY EASTBOUND. ELIMINATE WESTBOUND MOVEMENTS TO MAIN STREET.
- WEST OF BRIDGE: TWO-WAY ONLY TO PROVIDE ACCESS TO AND FROM BATTELL BLOCK.
- RESTRICT SIDEWALK ACCESS ALONG PARK ADJACENT TO TEMPORARY BRIDGE.
- PROVIDE PEDESTRIAN BRIDGE SOUTH OF TEMPORARY BRIDGE.
- DISCONTINUE ACTR BUS SERVICE AT THIS LOCATION.
- MERCHANTS ROW ON STREET PARKING.
 EXISTING: 40
 PROPOSED: 39

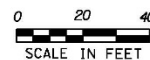

PROJECT NAME: MIDDLEBURY	PLOT DATE: 3/27/2017
PROJECT NUMBER: EWPS(1)	DRAWN BY: K.C. BARRY
FILE NAME: temp_bridge_Merchants	CHECKED BY: E.P. DETRICK
PROJECT LEADER: A.P. GUYETTE	SHEET 3 OF 4
DESIGNED BY: D.M. PECK	
MERCHANTS ROW TEMP. BRIDGE PLAN	

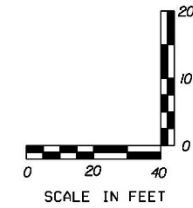
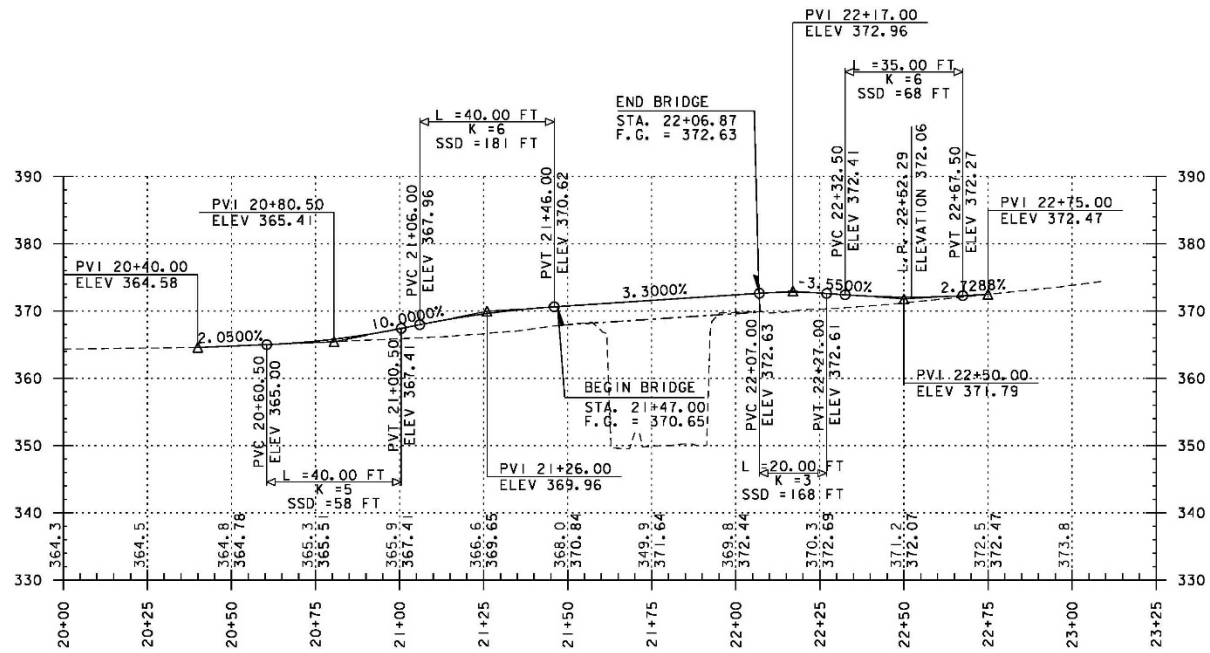

PROJECT NAME: MIDDLEBURY
 PROJECT NUMBER: EWPS(I)



FILE NAME: temp_bridge_Merchants	PLOT DATE: 3/27/2017
PROJECT LEADER: A.P. GUYETTE	DRAWN BY: K.C. BARRY
DESIGNED BY: D.V. PECK	CHECKED BY: E.P. DETRICK
MERCHANTS ROW TEMP. BRIDGE PROFILE	SHEET 4 OF 4



Temporary Bridges

- Temporary bridges are designed all legal loads
- Evaluating pedestrian bridge structure options currently
- Traffic Management Plan is being developed
- Costs 95% Federal and 5% State – No additional local share



Installation Schedule

- Preliminary Plans Complete Mid April
- Begin Construction in June
 - 2 weeks of approach/ prep work prior to bridge construction
 - 9 day closure to remove existing and install temp each bridge
 - Main St replaced first
 - Flexibility in Schedule for construction of Merchants Row
 - Complete both by mid- August



Questions?