

Stored Truss Inventory

This following are historic trusses that are stored either in place at their original location or in towns around the State of Vermont. All have the potential to be rehabilitated for use on town highways, sidewalks, bike paths, etc. Please contact JB McCarthy at JB.McCarthy@vermont.gov for more information or to discuss potential projects where these trusses could be used.

| | |
|--------------------------|--------------------------|
| <u>Original Bridge:</u> | Arlington No. 25 |
| <u>Length:</u> | 85' |
| <u>Year Built:</u> | 1927 |
| <u>Type:</u> | Warren Pony Truss |
| <u>Storage Location:</u> | Clarendon |

| | |
|--------------------------|---------------------------------|
| <u>Original Bridge:</u> | Corinth No. 34 |
| <u>Length:</u> | 54' |
| <u>Year Built:</u> | 1900 |
| <u>Type:</u> | Pratt Pin-Connected Pony |
| <u>Storage Location:</u> | Newbury |

| | |
|--------------------------|--------------------------|
| <u>Original Bridge:</u> | Berlin No. 72 |
| <u>Length:</u> | 90' |
| <u>Year Built:</u> | 1926 |
| <u>Type:</u> | Warren Pony Truss |
| <u>Storage Location:</u> | Montpelier |

| | |
|--------------------------|--------------------------|
| <u>Original Bridge:</u> | Fairfield No. 52 |
| <u>Length:</u> | 89' |
| <u>Year Built:</u> | 1914 |
| <u>Type:</u> | Warren Pony Truss |
| <u>Storage Location:</u> | Clarendon |

| | |
|--------------------------|---------------------------------|
| <u>Original Bridge:</u> | Burke No. 25 |
| <u>Length:</u> | 66' |
| <u>Year Built:</u> | 1907 |
| <u>Type:</u> | Pratt Pin-Connected Pony |
| <u>Storage Location:</u> | Burke |

| | |
|--------------------------|----------------------------|
| <u>Original Bridge:</u> | Montpelier No. 6 |
| <u>Length:</u> | 140' |
| <u>Year Built:</u> | 1929 |
| <u>Type:</u> | Pratt Through Truss |
| <u>Storage Location:</u> | Montpelier |

| | |
|--------------------------|------------------------------|
| <u>Original Bridge:</u> | Bethel No. 4 |
| <u>Length:</u> | 56' |
| <u>Year Built:</u> | 1896 |
| <u>Type:</u> | Lenticular Pony Truss |
| <u>Storage Location:</u> | Renaud Bros. |

| | |
|--------------------------|-----------------------------------|
| <u>Original Bridge:</u> | Medburyville |
| <u>Length:</u> | 98' |
| <u>Year Built:</u> | 1896 |
| <u>Type:</u> | Double Int. Warren Through |
| <u>Storage Location:</u> | Medburyville |

| | |
|--------------------------|------------------------------------|
| <u>Original Bridge:</u> | Cavendish No. 45 |
| <u>Length:</u> | 88' |
| <u>Year Built:</u> | 1890 |
| <u>Type:</u> | Pratt Pin-Connected Through |
| <u>Storage Location:</u> | Cavendish |

| | |
|--------------------------|---------------------------|
| <u>Original Bridge:</u> | Morrisville No. 53 |
| <u>Length:</u> | 83' |
| <u>Year Built:</u> | 1900 |
| <u>Type:</u> | Warren Pony Truss |
| <u>Storage Location:</u> | Morristown |

| | |
|--------------------------|--------------------------|
| <u>Original Bridge:</u> | Poultney No. 5 |
| <u>Length:</u> | 80' |
| <u>Year Built:</u> | 1928 |
| <u>Type:</u> | Warren Pony Truss |
| <u>Storage Location:</u> | Clarendon |

Example VT Project:

Original Bridge: [Wallingford No. 50](#) Length: 70' Year Built: 1929 Type: [Warren Pony Truss](#)

Storage Location: [Rehabilitated on W. Dover, VT bike path.](#)



Example Bridge/Truss Styles:

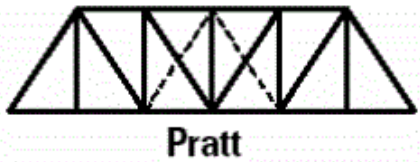

Pratt



Warren

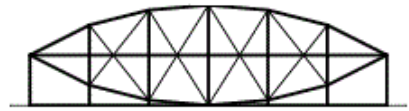

Lenticular

Pratt Through Truss



Warren Pony Truss



Lenticular Pony Truss

