

APPLICANT: _____ MILE POST: _____

TRANSVERSE OVERHEAD WIRELINE CROSSING
 (for VTrans use only – do not write in this box)

railroad: _____ mile post no.: _____ town: _____

applicant: _____ date: _____

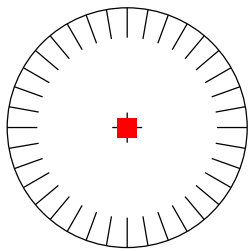

Place arrow indicating north direction relative to crossing.

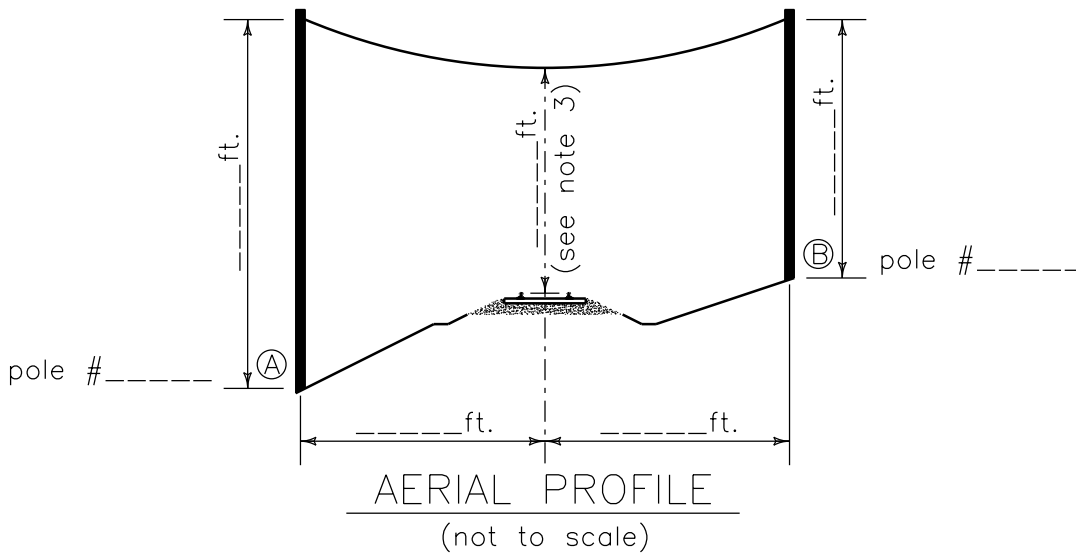
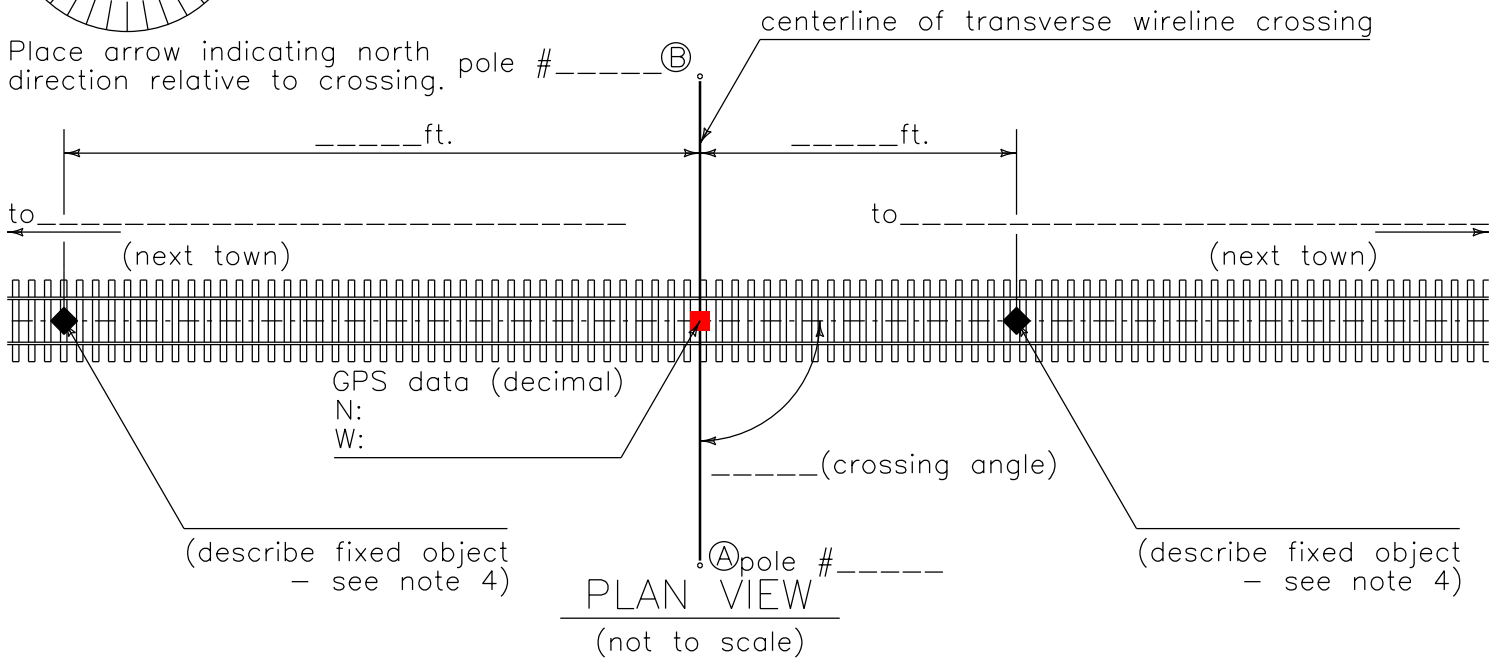

1. All dimensions must be filled in to process this application.
 2. All horizontal distances to be measured at right angles from the centerline of the railway/ railtrail except as noted.
 3. Minimum 23'-6" clearance above top of rail required per the National Electrical Safety Code.
 4. Fixed objects include: centerline of bridge; centerline of highway crossing (give name of highway); centerline of culverts; or railroad mile post.
 5. For aerial span guy, guy anchor & wire, and/or push brace pole, please submit additional plan & profile. These items must be installed a minimum of 30' from the track centerline.
- A. Is the transverse wireline crossing within highway right-of-way? _____ yes: _____ no
- B. If "yes", name of highway _____
- C. Type of transverse wireline crossing: _____ telephone: _____ CATV: _____ fiber optic: _____ copper: _____ other _____
- E. Voltage carried? _____ Electric phase? _____ Number of wires? _____
- F. Will any attachments be made to any existing utility poles? _____
- G. Does your business have existing utility crossings at this location? _____